

Good Neighbor Authority
Wisconsin Department of Natural Resources
Great Divide Ranger District
Sawyer County, WI

DNR Contact: David Todus - (715) 577-1806

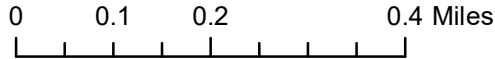

Timber Sale: Little Cranberry Lake

Legal Description:
 T40N R6W Sec. 14
 T40N R6W Sec. 15
 T40N R6W Sec. 22
 T40N R6W Sec. 23

Tract Number: 8003-01-23

Acres: 94

Cutting Prescription

Red Pine Thinning Area (C.465 S.27) 69 acres.

- Cut all trees marked with Blue Paint.

Oak Thinning Area (C.465 S.10) 16 acres.

- Cut all Aspen containing one or more pulpsticks. In addition, cut all other trees marked with Blue Paint.
- Oak Wilt Restricted: No harvest operations April 15th – July 15th.

Clear Cut Area (C.465 S.110, 127) 9 acres.

- Cut all trees 2 inches and greater. Logging slash from all severed stems must be piled at a minimum of a pile per acre.

General Sale Conditions:

- Sale is bounded by **Orange Paint**. Do not harvest Orange painted trees.
- Utilization will be to a 4" top.
- Leave uncut all standing snag and den trees that do not pose a safety hazard.
- All slash shall be lopped and scattered so it lies within 2ft of the ground and kept out of wetlands.
- Maintain 10ft. wide slash-free zones along FR720, FR720B, County Hwy B, and Existing Unclassified Woods Road.
- Road ID's W234412 and W234411 are decommissioned and will not be permitted for use as access to County Hwy B.
- Existing Temporary Road 1 will be closed with an earthen/debris berm following harvest by purchaser.
- The Existing Unclassified Woods Road, FR720, and FR720B doubles as Snowmobile Trail #21 and #18 and have use restrictions during snow conditions. See Prospectus for details.
- Operability is Frozen or Dry Summer/Fall.



Legend

- Red Pine Thinning Area
- Oak Thinning Area
- Clear Cut Area
- Lake
- Sections
- County Highway
- Woods Roads
- Existing Temporary Road

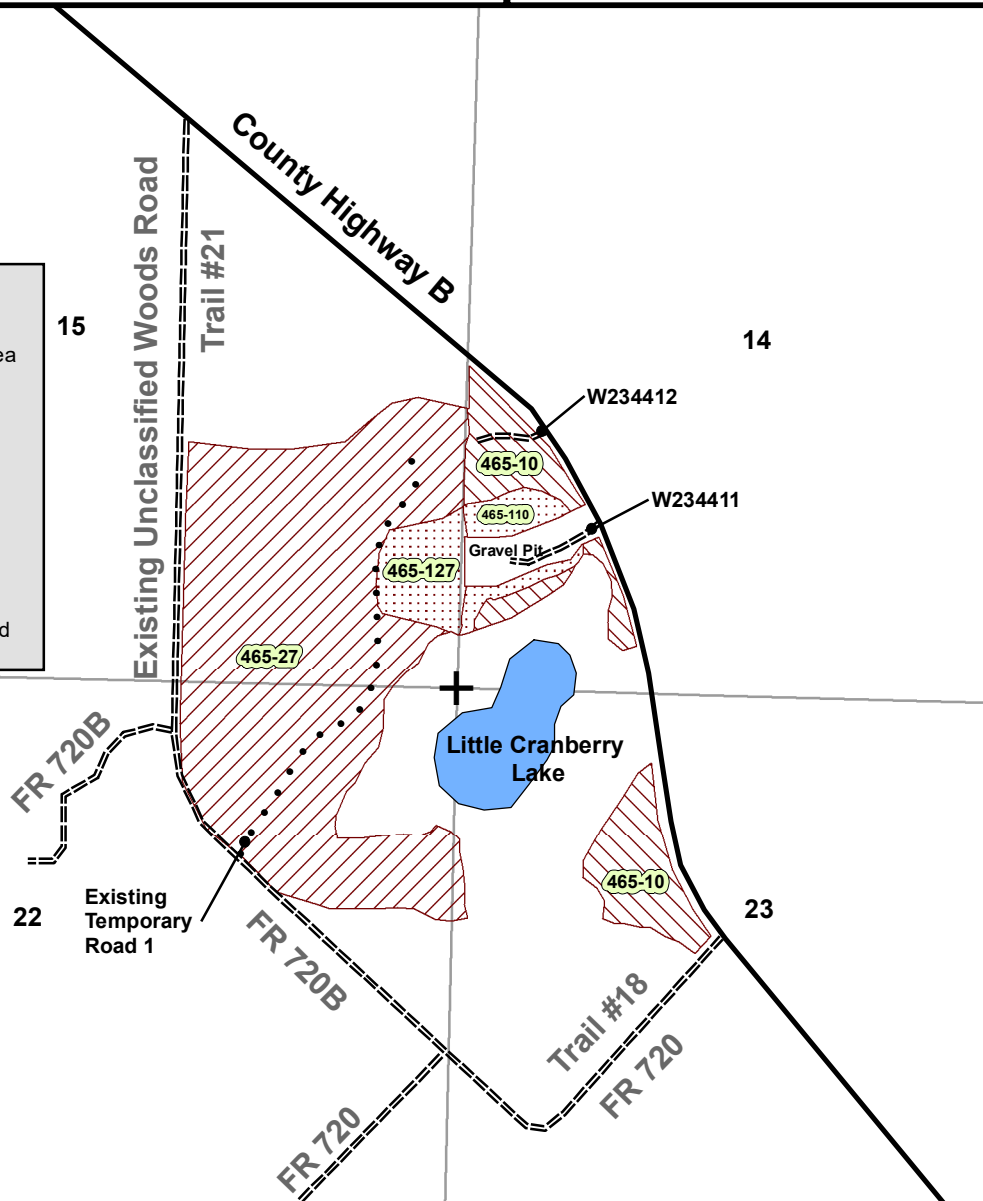

This Map is not a survey of the actual boundary of any property this map depicts.



Good Neighbor Authority Timber Sale

Little Cranberry Lake Sale

Great Divide Ranger District

Chequamegon-Nicolet National Forest

Tract # 8003-01-23

Sale Area: 94 Acres

Location:

Town	Range	Section	Description
40N	6W	14	W1/2SW
40N	6W	15	NESE, S1/2SE
40N	6W	22	N1/2NE
40N	6W	23	NW1/4

SPECIES	VOLUME	Conversion Rate (Tons/Cord)
Red Pine	1,385 Cords	2.25
Aspen	250 Cords	2.25
Red Oak	30 Cords	2.75
Mixed Hdwd	20 Cords	2.40
Basswood	10 Cords	1.925
White Pine	15 Cords	2.10
Tamarack	30 Cords	2.325
Balsam Fir	5 Cords	2.125

- Mixed Hardwood volume is estimated 50% Red Maple, 40% Sugar Maple, and 10% White Birch.
- Red Pine mixed product contains an estimated 110MBF based on an 8 inch DIB small end and 1,110 cords.
- White Pine mixed product contains an estimated 3MBF based on an 8 inch DIB small end and 8 cords.
- Sugar Maple conversion rate is 2.55tons/cord.
- Red Maple conversion rate is 2.275tons/cord.
- White Birch conversion rate is 2.40tons/cord.
- Any Hardwood Sawtimber will be scaled and charged as cordwood.

Minimum Bid Value: \$41,950.50

Harvest Requirements:

Red Pine Thinning Area: (C.465 S.27) 69 acres – Cut all trees marked with Blue Paint.

Oak Thinning Area: (C.465 S.10) 16 acres – Cut all Aspen containing one or more pulpsticks. In addition, cut all other trees marked with Blue Paint. Oak wilt Restricted: No harvest operations April 15th – July 15th.

Clear Cut Area: (C.465 S.110, 127) 9 acres – Cut all trees 2 inches and greater. Logging slash from severed stems must be piled at a minimum of a pile per acre.

Sale is bounded by **Orange Paint**. Do not harvest Orange painted trees.

Additional Requirements:

- **This Contract Period is Approx. 2 Years.**
- **Contract ending date is December 31st, 2025. No Contract Extensions will be awarded.**
- **This sale may be cut during FROZEN or Dry Summer/Fall ground conditions.**
- No bid bond required, a performance bond of 15% of the total sale bid value will be required.
- Sale will be mill scaled sale and billed using the mill ticket system.
- Utilization will be to a 4 inch top.
- Leave uncut all standing snag and den trees that do not pose a safety hazard.
- All slash shall be lopped and scattered so it lies within 2ft of the ground and kept out of wetlands.
- Maintain 10ft wide slash-free zones along FR720, FR720B, County Hwy B, and Existing Unclassified Woods Road.
- Road ID's W234412 and W234411 are decommissioned and will not be permitted for use as access to County Hwy B.
- Existing Temporary Road 1 will be closed with an earthen/debris berm following harvest by purchaser.
- Equipment must be inspected by sale administrator and clean of dirt and debris before entering sale area.
- Safety signs are required on public trails and roads entering active harvest areas.
- The Purchaser agrees that cut pine may not be kept on site for more than 21 days from May 1st through Aug 31st.

Road and Skid Trails:

- All landings and skid trails should be blocked to vehicular access and possibly re-seeded at the conclusion of use if needed.
- All road maintenance and rehabilitation post-harvest is the purchaser's responsibility. A sample contract including road maintenance specifications can be obtained by request.
- Contact WDNR Forester David Todus at (715)577-1806 or david.todus@wisconsin.gov for more information.

Recreational Trails

- The Existing Unclassified Woods Road, FR720, and FR720B doubles as Snowmobile Trail #21 and #18. Maintain a 10ft wide slash free zone adjacent to the trail. Use of trail for forwarding and decking is allowed during non-snow conditions. During snow conditions Trail #21 and #18 weekend, holiday, and use restrictions apply. For protection of motorized trails design feature applies to trails and not entire stand:
 - 1) No hauling activities allowed during spring closure (March 15 – April 30th) and during snow conditions on weekends or holidays (weekends are Friday 6 pm through Sunday at midnight; possible holidays include: Thanksgiving, Christmas Eve, Christmas, New Year's Eve & New Year's).
 - 2) If the trail is closed during logging operations, decks and landings can be placed on the trail bed. Where groomed trails are utilized for haul routes for winter operations, a mat of hard packed snow will always be maintained on the trail, except on short segments of steep (>15%) slopes.
 - 3) For trails that remain open while being used for haul routes, signs notifying trail users to slow down and be aware of logging ahead will be posted on each end of the trail where timber harvest and hauling activities are occurring. Caution signs will also need to be placed at major intersections of roads that provide access to recreation sites or other trails. Timber activities occurring adjacent to motorized trails that are open for use during the logging operations will locate decks perpendicular to the trail in a way to prevent loading on the trail if possible.
 - 4) Skidding or forwarding will not be allowed on designated snowmobile Trail #21 during snow conditions, except to cross at right angles at designated crossings. In general, where trails are utilized for logging operations, the existing trail widths (tread width) will be maintained to a maximum of 12 feet wide.

Notice: Completion of this form is mandatory. The Department will not recognize your bid unless you complete and submit this form. Personal information collected will be used for program administration and may be provided to requesters as required by Wisconsin's Public Records law [ss. 19.31-19.39, Wis. Stats.].

Date

Bidder Name			
-------------	--	--	--

Street Address	City	State	ZIP Code
----------------	------	-------	----------

Property Name (if any) CNNF - Great Divide Ranger District	Timber Sale Name Little Cranberry Lake	Tract Number 8003-1-23
---	---	---------------------------

Date and Hour of Bid Opening September 15, 2023 @ 1:30pm	Minimum Acceptable Bid (optional) \$41,950.50
---	--

Species-All bids including Lump Sum bids must be by species	Utilization Specifications (4 inch/Whole Tree/Logs)	Estimated Volume	Volume Units (tons/cords/mbf)	Price Bid Per Unit	Total Bid Value on Estimated Volume
Red Pine	4 in	1,385	Cords		
Aspen	4 in	250	Cords		
Red Oak	4 in	30	Cords		
Mixed Hardwood	4 in	20	Cords		
Basswood	4 in	10	Cords		
White Pine	4 in	15	Cords		
Tamarack	4 in	30	Cords		
Balsam Fir	4 in	5	Cords		

The award shall be based on this TOTAL BID AMOUNT:

Performance Bond Will be in the form of: (select one)

Personal Check
 Assurance Bond
 Certified Check/Money Order
 Certificate of Deposit
 Irrevocable Letter of Credit
 Assignment of Savings Account

I understand that any or all bids may be rejected and that consideration and awarding of a contract will be based upon my past performance and ability to complete contracts. **I also understand that if I am the winning bidder, I have 6 weeks from the date of the bid opening to submit an acceptable performance bond. I also understand that if I am awarded the contract and fail to execute it or work under it, I will be required to forfeit to the Department an amount equal to 10% of my total bid amount.** Failure to forfeit the 10% penalty will result in being considered ineligible to bid on any state timber sales for a two-year duration. In the event the highest bidder can not or will not sign the contract, the award may be made to the next highest qualified bid.

By checking this box, I certify that I hold a Wisconsin Master Logger Certification.

Notice: I understand:

Utilization specifications and estimated volumes are listed in the prospectus which is available upon request from the Department.

A copy of the standard timber sales contract which must be entered into is available upon request from the Department.

Signature of Bidder
Bidder's Name (Please Print or Type)
Phone Number (include area code)
Email Address