

Good Neighbor Authority
Wisconsin Department of Natural Resources
 Eagle River-Florence Ranger District
 Chequamegon-Nicolet National Forest
 Sections 28 & 29, T38N R15E
 Florence County, WI

Siren Timber Sale
Tract Number: 8002-05-19

156 Total Acres

Legend	
	Northern Hardwood Selection/Improvement
	Aspen Overstory Removal
	Orange Boundary Line
	Equipment Exclusion
	Private Property Line
	Other Ownership
	Woods Road
	Snowmobile Trail
	Streams
	Section Line
	Section Corner
	Survey Monument

DNR Contacts:
 Tyler Wood – (715) 889-3234
 Mapped by: Hillary Keller 03/19/19

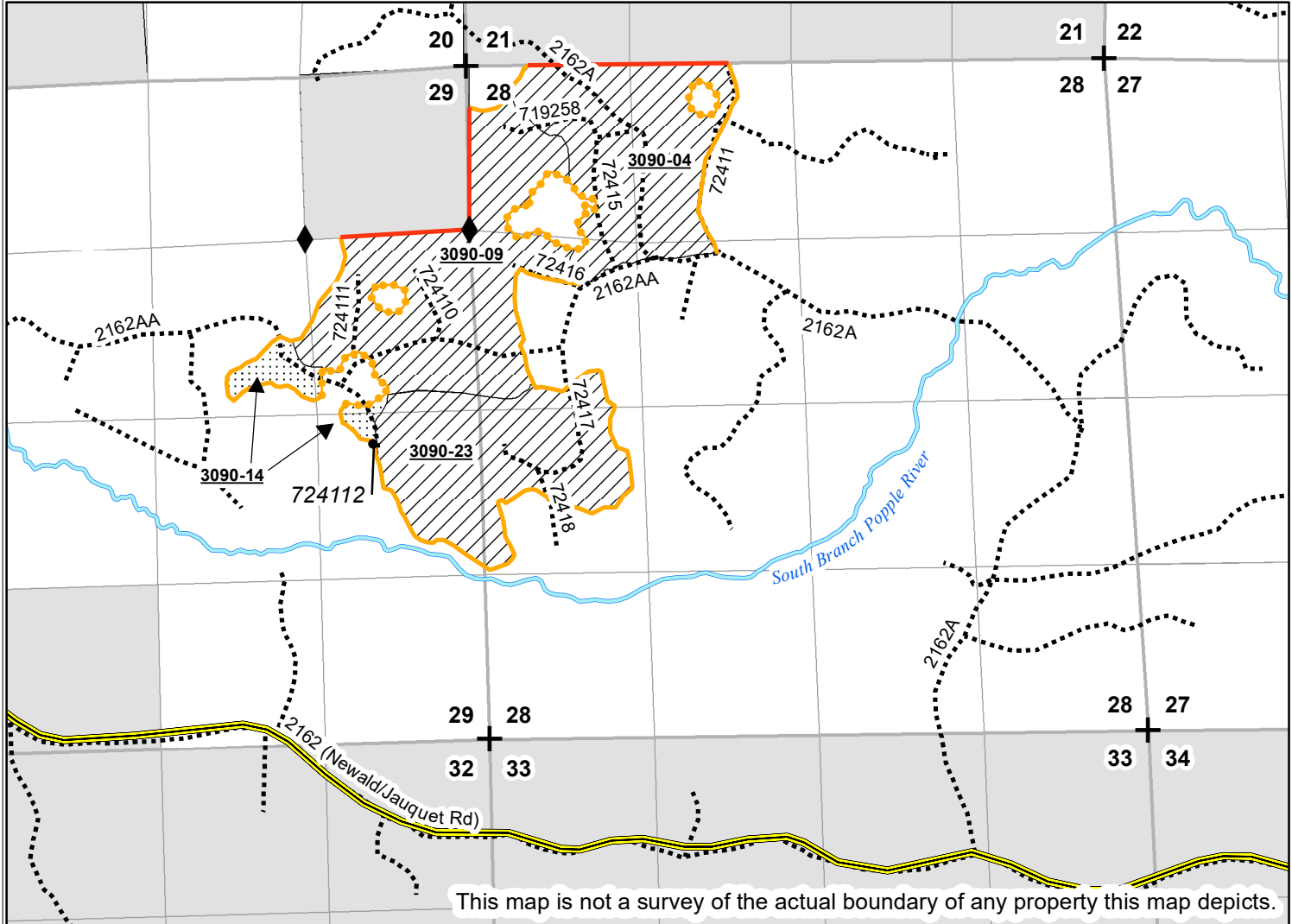

This map is not a survey of the actual boundary of any property this map depicts.

0 0.5 1 Miles 1 in = 1,320 ft

Cutting Prescription:

- N. Hardwood Selection and Improvement (149 Acres):** Stands 3090-04, 3090-09, 3090-23
- Aspen Overstory Removal (7 Acres):** Stand 3090-14

- Harvest all trees marked with **Blue Paint**.
- Scattered gaps were created by marking all trees and stems over 1 inch in diameter with **BLUE PAINT** within a determined area (approx. 25-60 feet across). All stems over 1 inch in diameter that are marked with **BLUE PAINT** should be cut to create the gap.
- Cut all merchantable ironwood.
- Leave all standing snag and den trees that do not pose a safety hazard uncut.
- Damage to any residual trees will not be tolerated.
- Utilization will be to at least a 4 inch top.

General Sale Conditions:

- **Seasonal Restrictions:** harvesting and site-disturbing activities **may not occur** from April 1 through October 1. Harvesting will **only occur under frozen ground conditions**.
- Sale boundaries, reserve areas, and leave trees are marked with **Orange Paint**. Private property lines are marked with **Red Paint**.
- Do not harvest trees or operate equipment across **Orange and Red Paint** lines.
- Equipment must be cleaned and inspected by the DNR Sale Administrator before entering or leaving sale area to prevent the introduction/spread of invasive species.
- Purchaser required to post signs on USFS roads alerting recreationalists of timber harvest activities.
- All slash shall be pulled 10 feet from the edge of all roads, trails, private property lines, and riparian areas and should be lopped and scattered to lie within 2 feet of the ground for 100 feet from the South Branch Popple River edge.





Good Neighbor Authority
Wisconsin Department of Natural Resources
 Eagle River/Florence Ranger District
 Chequamegon-Nicolet National Forest

Siren Sale - Prospectus
Tract No.: 8002-05-19

Location: Florence County, WI

38N	R15E	28	SW ¼, NW ¼
38N	R15E	29	SENE, SWNE, NESE

Estimated Volumes and Values

Species	Cords	MBF
Hard Maple		55
Mixed Hardwood ¹	1350	30
Aspen	65	
Balsam Fir	5	
TOTALS	1420 Cords	85 MBF

Minimum Acceptable Bid: \$48,847.00

All volume estimates were obtained using the "Forest Metrix" volume estimating system. Plot data includes measuring individual tree diameter and # of 8 foot sticks per sample tree to calculate volumes.

¹ Mixed hardwood cordwood contains approximately 53% hard maple, 39% basswood, 3% ironwood, 3% red maple, 2% black cherry, and less than 1% each of yellow birch, white ash, and black ash. Mixed hardwood sawtimber contains approximately 93% basswood, 4% white ash, 3% red maple, and less than 1% black cherry.

The mixed hardwood cordwood conversion rate will be 2.3 tons per cord.

Sale Conditions:

- Mill Scale Sale
- No bid bond required
- A performance bond of 15% of the total sale bid value required
- The cutting area is approximately **156 acres**
- **The contract period is 3 years**
- **Harvesting will only occur during frozen ground conditions.**
- **Harvesting or other site-disturbing activities may not occur from April 1 to October 1.**
- Sale bounded by **ORANGE boundary paint, RED private property line paint**, and established roads. See sale maps for specifics
- Do not harvest trees, drop slash, or operate equipment across **ORANGE or RED** paint lines. Reserve areas are delineated by 3 vertical **ORANGE** dots.
- Damage to any residual trees will not be tolerated
- Leave all standing snag and den trees that do not pose a safety hazard uncut
- Utilization will be to a 4" top

- **Cutting Prescriptions**
 - Northern Hardwood Selection: Stands 3090-04, 3090-09, 3090-23
 - Harvest all trees marked with **BLUE PAINT**.
 - Scattered gaps were created by marking all trees and stems over 1 inch in diameter with BLUE PAINT within a determined area (approximately 25 to 60 feet across). All stems over 1 inch in diameter that are marked with BLUE PAINT should be cut to create the gap.
 - **Cut all merchantable ironwood.**
 - Aspen Overstory Removal: 3090-14
 - Harvest all trees marked with **BLUE PAINT**.
 - **Cut all merchantable ironwood.**

Special Conditions:

- **NO SALE MAY BEGIN WITHOUT PRIOR NOTIFICATION AND AN ON-SITE MEETING WITH A WISCONSIN DNR SALE ADMINISTRATOR.**
- Purchaser required to post signs on USFS roads alerting recreationalists of thinning activities.
- **Snowmobile Restrictions: Hauling is prohibited on the Snowmobile Trails on Federal Holidays, weekends starting noon on Friday through midnight Sunday, and between Christmas Day and New Year's Day. At all times during the snowmobile season, keep at least 4 inches of packed snow on the trail. Keep trail clearing (10 feet from the edge of the trail) cleared of debris resulting from purchaser's operations as work progresses. Do not deck wood on inside curves, where it could obscure oncoming traffic.**
- Equipment must be cleaned and inspected by the DNR Sale Administrator before entering and leaving the sale area to prevent the introduction/spread of invasive species.
- Seasonal Restrictions:
 - **Harvesting will only occur under frozen ground conditions.**
 - **Harvesting or other site-disturbing activities may not occur from April 1 through October 1**
- All slash shall be pulled 10 feet from the edge of all roads, trails, private property lines, and riparian areas, **and shall be lopped and scattered to lie within 2 feet of the ground for 100 feet from the South Branch Popple River edge.**
- Chequamegon-Nicolet Forest Plan requires that all native surfaced approaches to paved or graveled roads have 100 ft. of gravel, 6 in. deep, 12 ft. wide put down when used during non-frozen conditions.
- The location and clearing widths of all Temporary Roads shall be agreed to in writing before construction is started. "Temporary Roads" are roads other than Specified Roads that are constructed by Purchaser for the purpose of harvesting included timber.
- When two or more commercial users are simultaneously using the same road, the commercial users will develop maintenance responsibilities and arrangements for accomplishing the work. Seller must agree to this plan. If the commercial users cannot agree on maintenance responsibilities, seller shall resolve the differences.
- Temporary roads shall be closed at the end of the sale with berms. Berms must be constructed at locations designated by DNR Sale Administrator and shall be created using the following design features:
 - Berms must be at least four feet in height
 - Berms must be made with dirt mixed with rocks, stumps, logs, root-wads, or slash and shall be created without creating a defined trench.
- The following roads will be decommissioned after use with a berm. Berms must be constructed at locations designated by the DNR Sale Administrator and shall be created using the above design features:
 - **Roads: 72415, 719258, 72416, 724110, 724111, 724112, 72418**

Road Restrictions List

Road Number	Road Name	Termini		Map Legend	Description of Restrictions
		From	To		
2162	Newald/Jauquet Road	Highway 139	2162A	R A	1. Use only during surface firm or frozen conditions. 2. Hauling is prohibited on the Snowmobile Trails on Federal Holidays, weekends starting noon on Friday, through midnight Sunday, and between Christmas Day and New Year's Day. At all times during the snowmobile season, keep at least 4 inches of packed snow on the trail. Keep trail clearing (10 feet from the edge of the trail) cleared of debris resulting from purchaser's operations as work progresses. Do not deck wood on inside curves, where it could obscure oncoming traffic.
2162A		2162	End of Use	R	1. Use only during surface firm or frozen conditions.
72411 719258 2162AA		2162A	End of Use	R	1. Use only during surface firm or frozen conditions.
72415		2162AA	719258	R	1. Use only during surface firm or frozen conditions.
72416 72417 724110 724111 724112		2162AA	End of Use	R	1. Use only during surface firm or frozen conditions.
72418		72417	End of Use	R	1. Use only during surface firm or frozen conditions.

Road Maintenance Requirements Summary

Purchaser shall maintain roads, commensurate with Purchaser's use. Roads must be left in as good or better condition than existed prior to harvest. Performance of road maintenance work by Purchaser may be required prior to, during, or after each period of use. The timing of work accomplishment shall be based on Purchaser's operating schedule and road conditions. Specific required road maintenance specifications are included below.

Purchaser shall maintain roads in accordance with the following Contract Road Maintenance Requirements Summary:

Contract Road Maintenance Requirements Summary

Road	Termini		Miles	Timing: Pre-haul During Post haul	Applicable Road Maintenance Specifications									
	From	To			8110	8420								
2162	Hwy139	2162A	4.13	During Post Haul	X									
2162A	2162	End of Use	1.85	During Post Haul	X									
72411	2162A	End of Use	0.31	During Post Haul	X									
719258	2162A	End of Use	0.23	Pre Haul	X	X								
2162AA	2162A	End of Use	0.70	During Post Haul	X									
72415	2162AA	719258	0.20	Post Haul	X	X								
72416	2162AA	End of Use	0.11	Pre Haul	X	X								
72417	2162AA	End of Use	0.32	Post Haul	X									
72418	72417	End of Use	0.12	Pre Haul	X	X								
724110	2162AA	End of Use	0.12	Pre Haul	X	X								
724111	2162AA	End of Use	0.14	Pre Haul	X	X								
724112	2162AA	End of Use	0.12	Pre Haul	X	X								

Specification No.	Specification Title
T-8110	Maintenance Blading/Grading
T-8420	Cutting Roadway Vegetation

T-8110: Maintenance Blading/Grading is keeping an aggregate surfaced Roadbed in a condition to facilitate traffic and provide proper drainage. It includes maintaining the Crown, Inslope or Outslope of the Traveled Way, Turnouts, and Shoulder; repairing Berms; blending approach road intersections; and cleaning Drainage Dips and Lead-off Ditches.

T-8420: This work includes removal of brush, trees and other vegetative growth from within the clearing limits. This may include brush mowing of shoulders to prevent larger growth which would inhibit travel in the future.